

Mika

Low-Voltage Track



● Black

Features



Dimensions

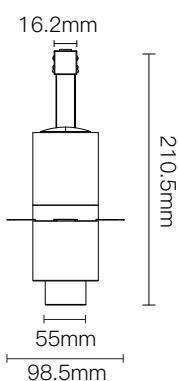
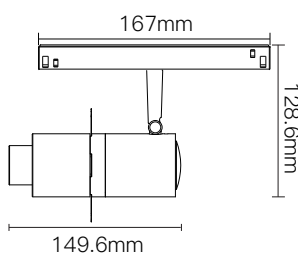

Electrical system

Total power consumption:	12W
Power input:	48V
Operating temperature:	-10°C ~ 35°C
Dimming option:	0-10V / Dali / Casambi
Insulation class:	Class III

Light source

LED type:	COB
CCT:	2700K/3000K/4000K
CRI:	Ra>90
Beam angle:	Beam shaper
UGR:	<10

Housing

Lamp body diameter:	55mm
Material:	Aluminum
Weight:	431g

Warranty

Period:	5-year warranty
----------------	-----------------

Lumen output

Angle \ CCT	2700K	3000K	4000K
Beam shaper	270lm	300lm	315lm

Nomenclature

*Applicable model: M41612xx90xxxx (xx: dynamic codes)

Product Code	System Power	CCT	CRI	Beam Angle	Driver/Control	Serial No.
M416	12(12W)	27(2700K)	90(90)	SP(Shaper)	N(Non-Dim)	01(Black)
		30(3000K)			A(0-10V dim)	
		40(4000K)			D(DT6)	
					E(DT8)	